



# cedar taylor district

streetscape and neighborhood identity improvements

Cedar Taylor Development Association  
Michelle Bandy-Zalatoris, AICP, LEED AP

City of Cleveland Heights  
City of University Heights



A photograph of a lively urban street. The scene is filled with mature trees showing autumn foliage in shades of green, yellow, and red. Several cars are parked along the street, and a few are in motion, blurred by the camera. Buildings with storefronts line the street, including one with a red and white striped awning. The overall atmosphere is bright and colorful, suggesting a pleasant, walkable neighborhood.

Livable neighborhoods  
with a vibrant street life  
will stimulate our  
economic life as well.

- Gavin Newsom

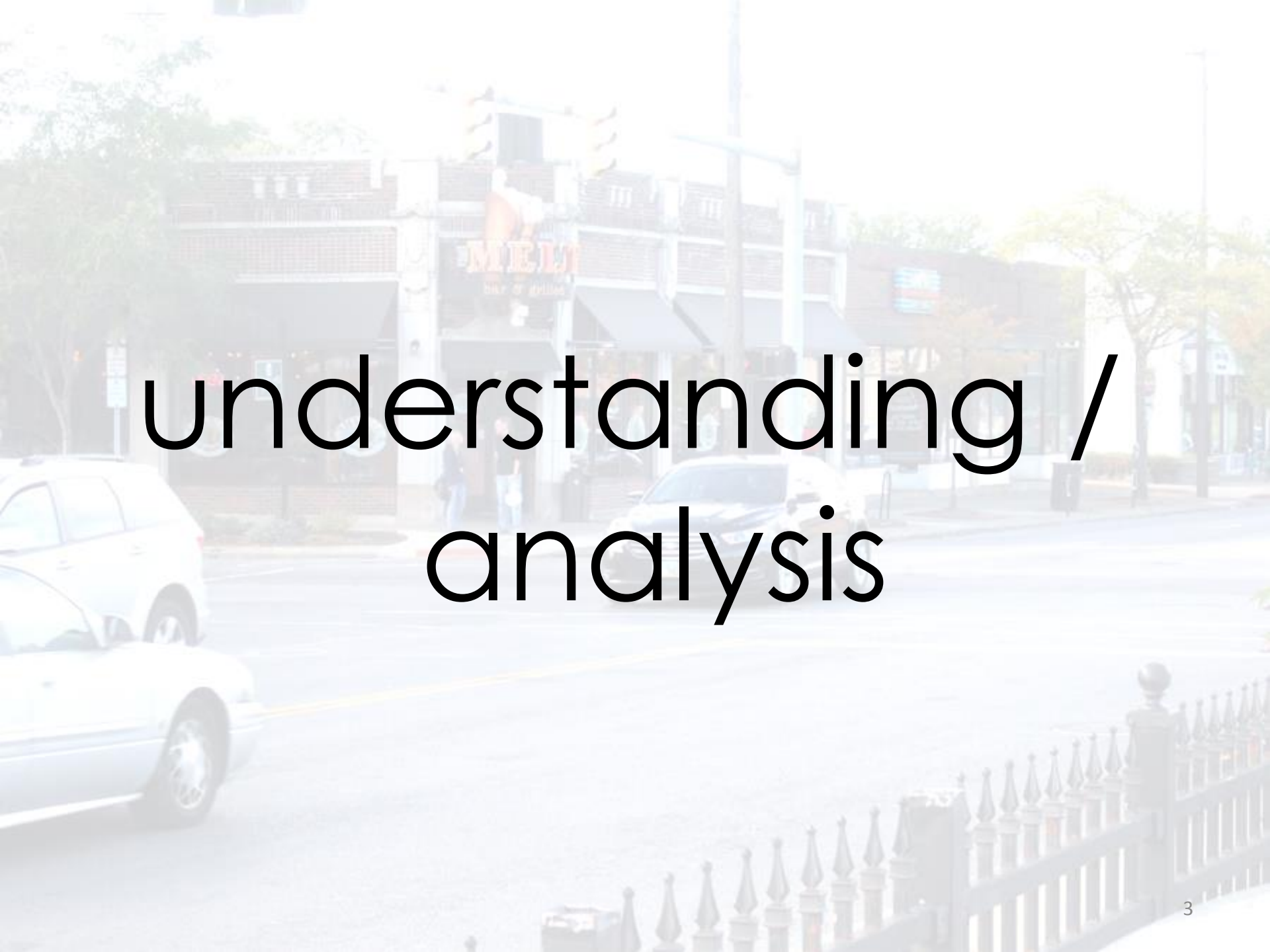

# understanding / analysis

# Merchant Survey

## Your responses

- The district's businesses are busy at various times throughout the day and the week, serving a wide range of customers from in and out of the neighborhood.
- The majority of respondents have been in the district for 10 years or more, and most anticipate staying for the foreseeable future.
- The 17 businesses that responded generate approximately 7,000 customers on a weekly basis.
- Nearly all customers arrive by automobile, creating a need for convenient, safe and accessible parking.
- There is a perception from customers that the district is deteriorating and unsafe. Maintenance issues and parking add to the challenges.
- The lack of cohesive identity makes it hard to market the district as a special place.
- The district's convenient location, visibility and traffic volumes are important.
- Special activities, better lighting and visual improvements would be helpful for supporting business.



# Existing conditions

Aerial photograph



cedar taylor district

**analysis**

# Existing conditions

## District businesses



cedar taylor district

**analysis**

# Existing conditions

## District details

Municipalities: Cleveland Heights and  
University Heights

Zoning district: C-2 Local retail

District length:  
South Taylor – 1,440' = .27 miles  
Cedar – 890' = .17 miles

Right-of-way width (average):  
South Taylor – 60'  
Cedar – 60' – 72'

Cartway width:  
South Taylor – 40' – 44'  
Cedar – 50'

Lane widths:  
South Taylor – 10', 11'  
Cedar – 12', 13'

Sidewalk widths (average):  
South Taylor – 10'-12'  
Cedar – 11'

Parking:

On-street parking (meters):  
South Taylor – 24 spaces  
Cedar – 17 spaces

Lot parking (private): 433 spaces

Lot parking (public): 74 spaces (with  
limited daytime availability)

Transit:

Bus shelters: 3

Bus routes: 32, 37

cedar taylor district

**analysis**

# Existing conditions

## Traffic issues

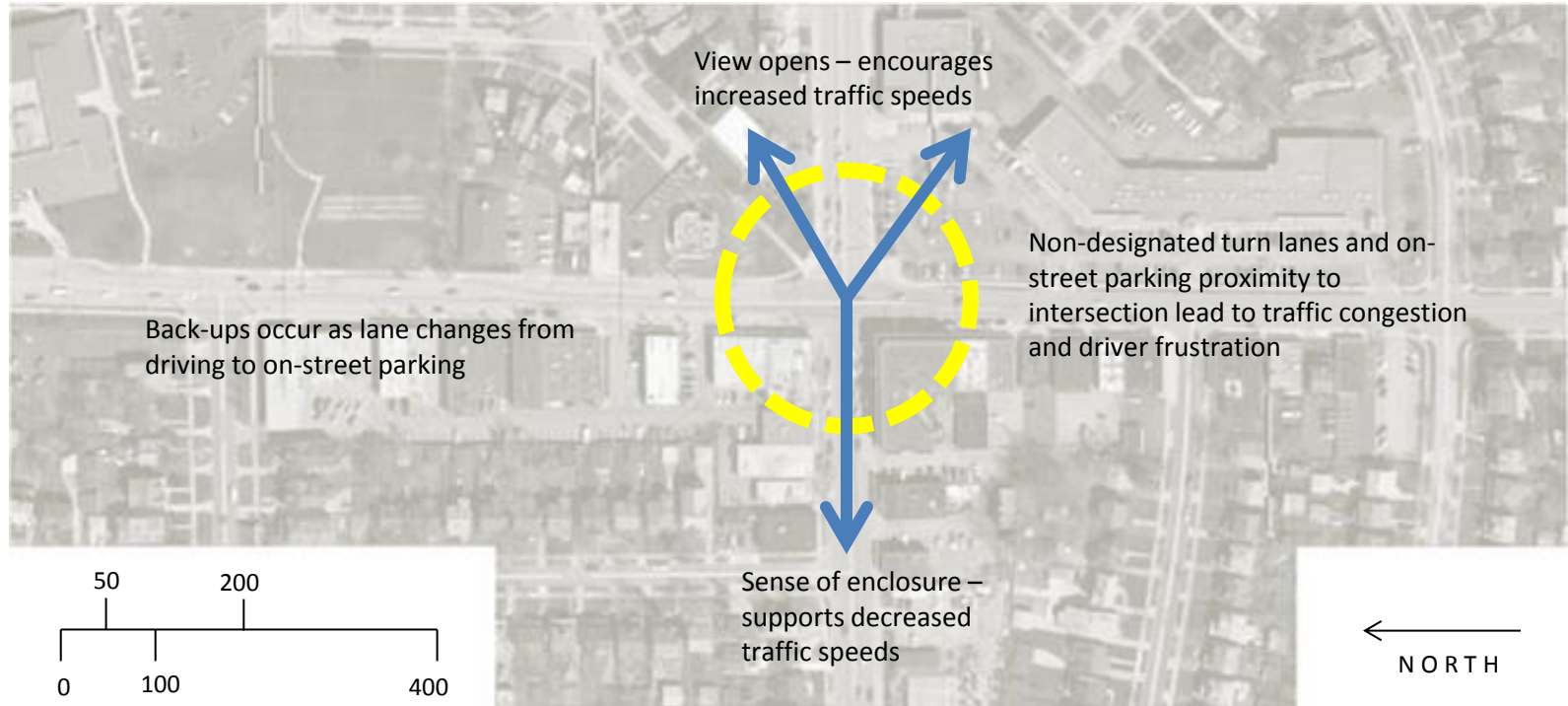

cedar taylor district

**analysis**



# Existing conditions

## Parking issues

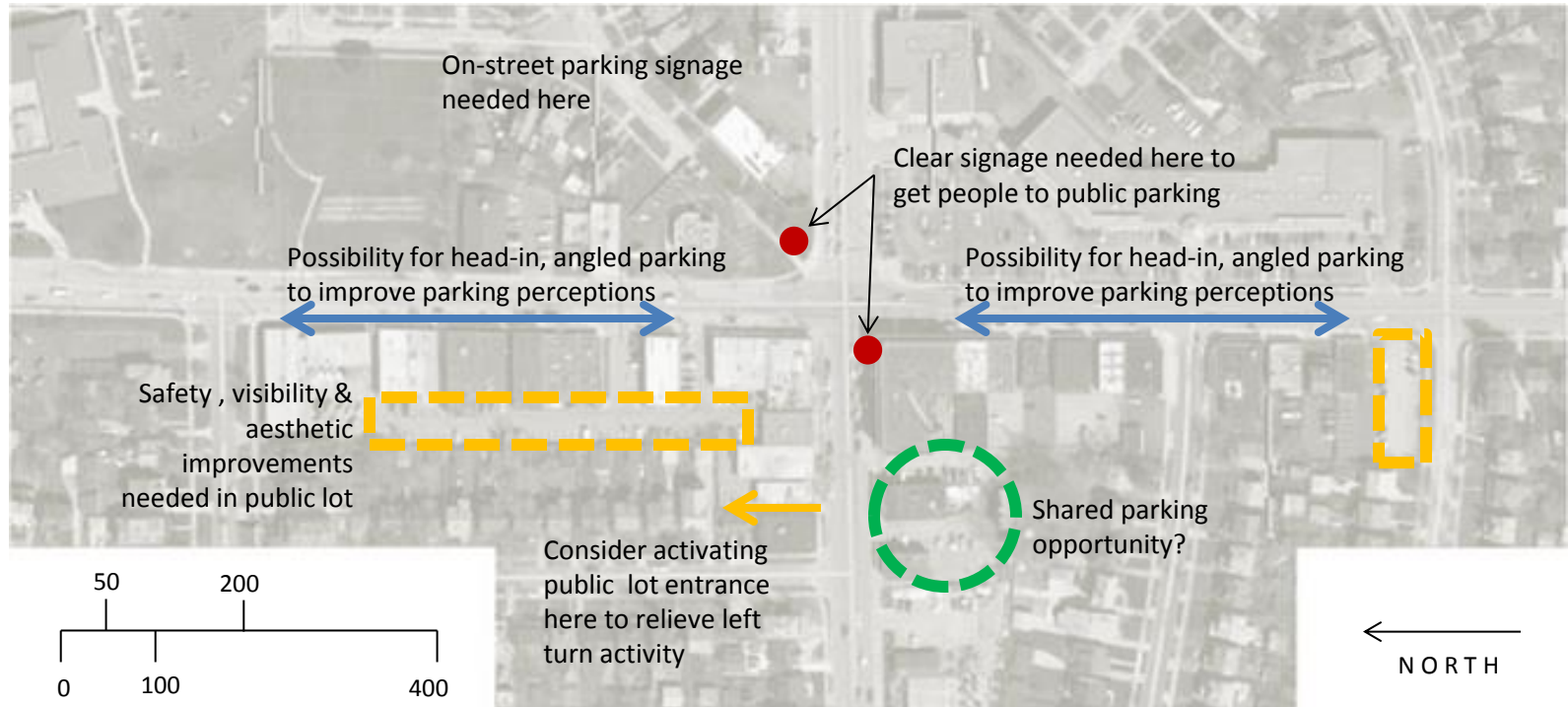

cedar taylor district

**analysis**

# Existing conditions

## Pedestrian environment

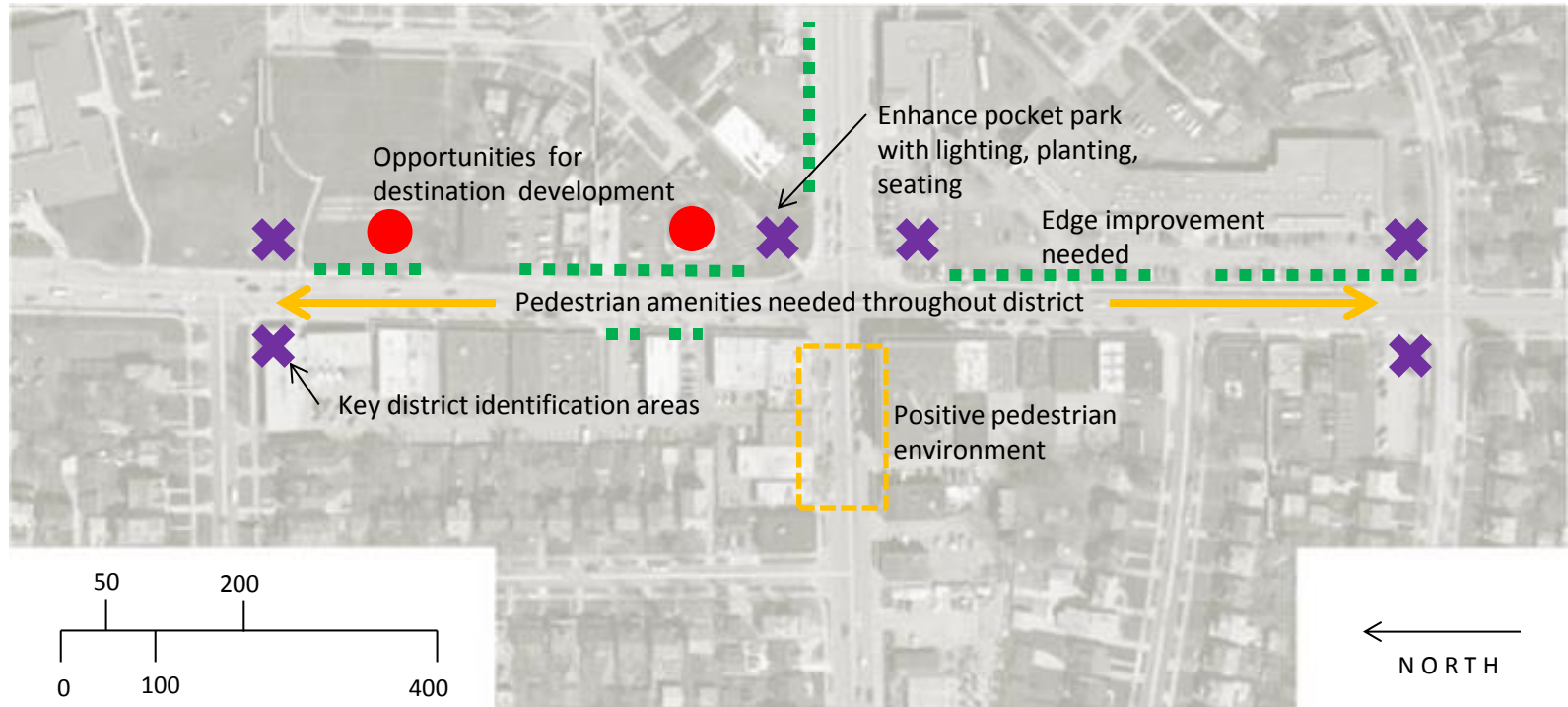

cedar taylor district

**analysis**

# Existing conditions

## District strengths

- The district supports a large amount of independently-owned, local businesses.
- Large portions of the original physical fabric remain.
- Much of the district has an authentic feel – something that has evolved naturally.
- There is a large amount of parking for business support.
- Many of the businesses / property owners have undertaken recent reinvestment and/or renovations for their property – demonstrating a fairly engaged set of stakeholders.
- The district supports many of the smaller, service-oriented businesses that many neighborhood districts lack.
- The district is extremely compact and walkable.
- The district is well-connected to surrounding neighborhoods.
- A significant amount of pass-through traffic creates an opportunity for great visibility.

cedar taylor district

**analysis**



# Existing conditions

## District strengths



cedar taylor district

**analysis**

# Existing conditions

## District weaknesses

- Current traffic patterns create frustration at heart of district.
- The intersection of South Taylor Road and Cedar Road feels congested.
- There is a *perceived* lack of parking for existing businesses.
- Current public parking feels removed and/or unsafe.
- Dramatic differences between spatial enclosure east and west of South Taylor Road create a sense of imbalance, disconnect and discomfort.
- Few pedestrian amenities exist within the district to support walking, lingering, etc.
- The presence of public parking lots is not clear to the first-time visitor.
- Complex rules for public parking in municipal lot add to discomfort – “is it okay to park here right now?”
- Lack of maintenance at key properties detracts from overall perceptions of district.

cedar taylor district

**analysis**

# Existing conditions

## District weaknesses



cedar taylor district

**analysis**



# Existing conditions

## District challenges

- The district is primarily service-oriented with a strong neighborhood focus. Many of the current businesses do not necessarily support a multi-stop visit. Consider additional complementary businesses for future tenants, i.e. – coffee shop, bank/atm machine, hardware, mini library/book drop-off, recycling center, etc.
- The district needs to feel convenient for a range of uses while incorporating elements that will slow traffic, encourage longer, multi-stop stays and encourage alternate modes of transportation. It is a delicate balance, but the character of the overall environment will make a significant impact on the success of this approach.
- Critical corner properties can make or break perceptions of the district. Encouraging a few more well-maintained destination businesses or activities will have a tremendous impact.
- The configuration and visibility of parking will be an important component of the district's growth and success.
- The encouragement of stakeholder partnerships and working together for the good of the entire district will be critical.

cedar taylor district

**analysis**

# Existing conditions

## District challenges



cedar taylor district

**analysis**

# Existing conditions

## District opportunities

- Provide simple, key elements to tie district together visually.
- As a gateway area for both cities, this district plays an important role in creating positive first impressions. What type of welcome mat is being provided here? The opportunity exists to create a unique and engaging identity that will serve both cities well.
- The district could serve as an experimental area for both cities to test new ideas. Its visibility can support the idea that both are forward-thinking and proactive.
- Wider sidewalks in portions of district allow for the inclusion of a range of elements to support a positive pedestrian environment.
- Alleys between buildings can be activated with additional amenities to turn them into assets. No 'leftover' spaces.
- Strengthening district identity and environment will not only support existing businesses, but will help to attract new ones.
- The green spaces along South Taylor Road are tremendous assets that can help to activate the district.

cedar taylor district

**analysis**



# Existing conditions

District opportunities



cedar taylor district

**analysis**



envisioning / ideas

# Infrastructure

Concepts for consideration

- Dedicated left turn lanes in all directions
- Rear angled parking along South Taylor Road
- Bike lanes along Cedar Road / sharrows or painted bike lanes
- Pedestrian light fixtures (solar or LED)
- Public parking lot improvements
- Power line to tree pits
- Updated bus stops
- Posted bus routes, bike routes and maps
- Bike safety signage / share the road reminders

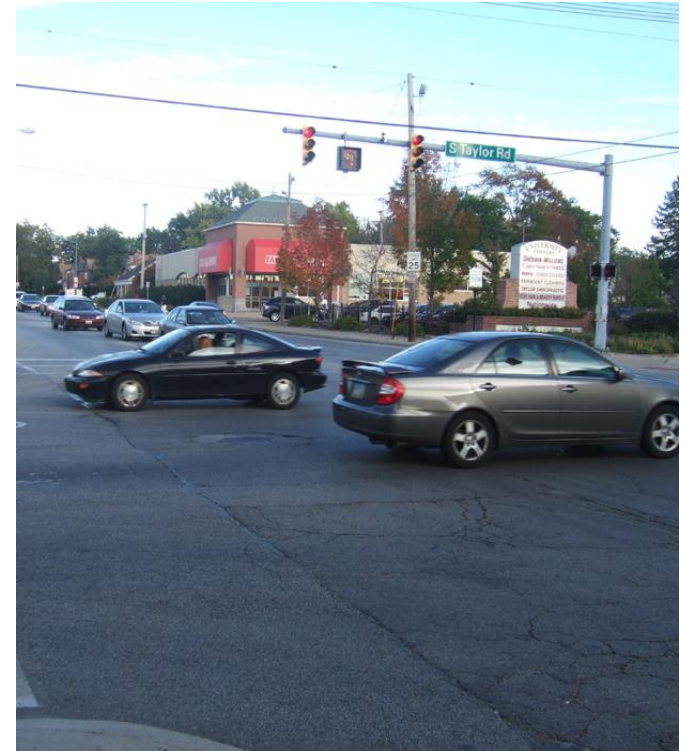

cedar taylor district

**idea book**



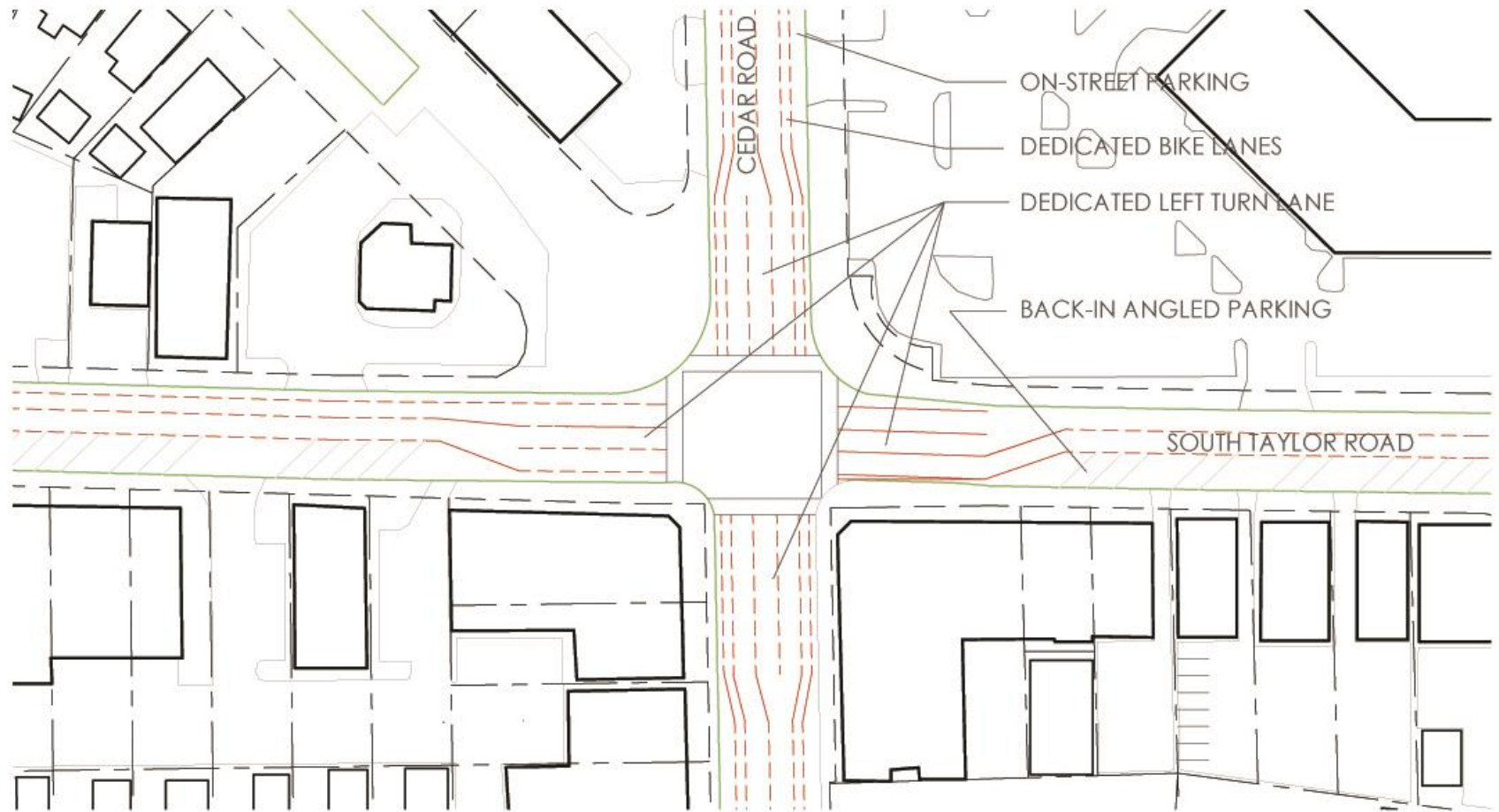

cedar taylor district

# idea book

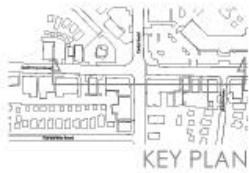

## PROPOSED DEDICATED TURN LANE - CEDAR ROAD

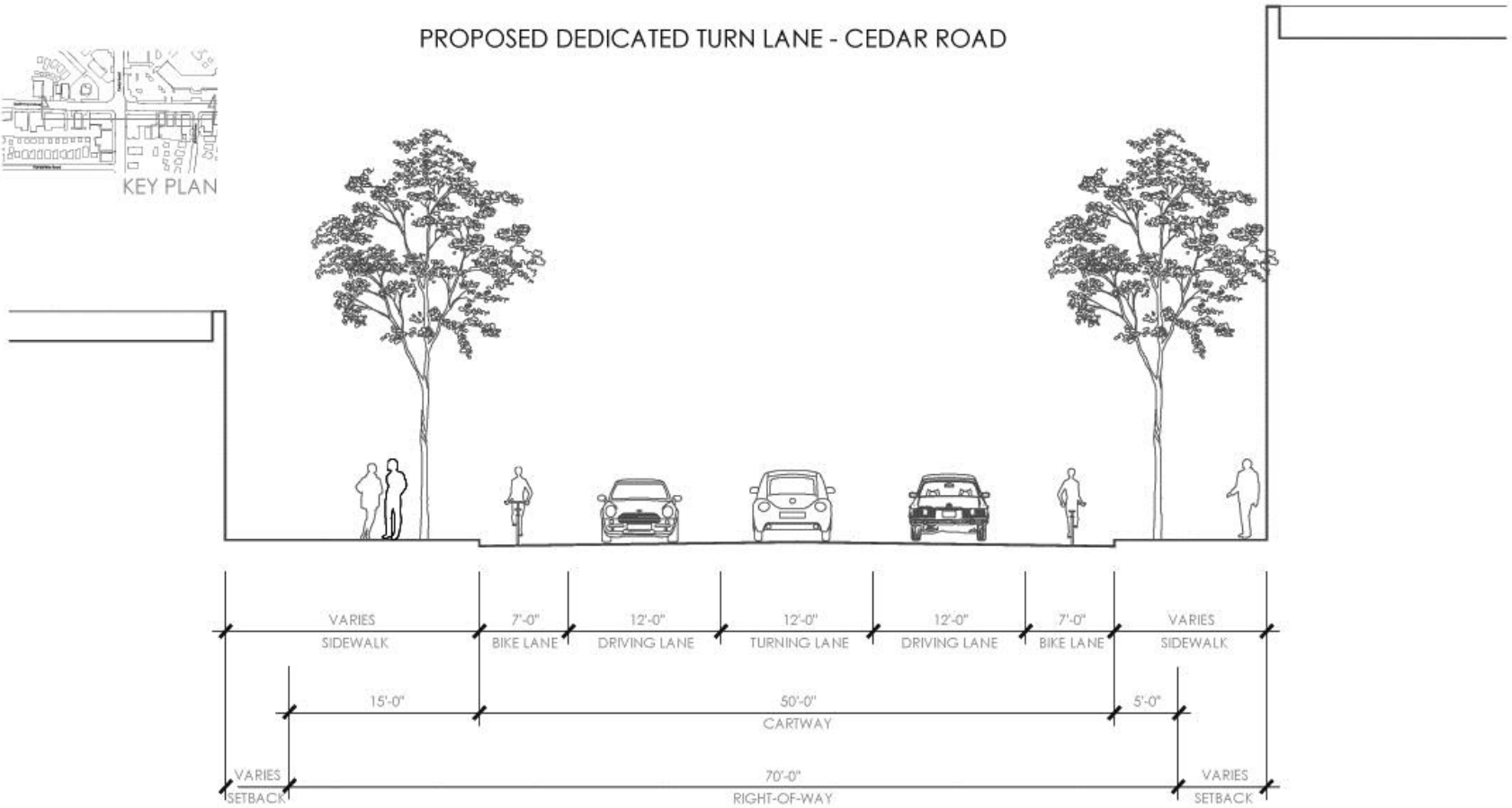

cedar taylor district

**idea book**

## PROPOSED DEDICATED TURN LANE - SOUTH TAYLOR ROAD

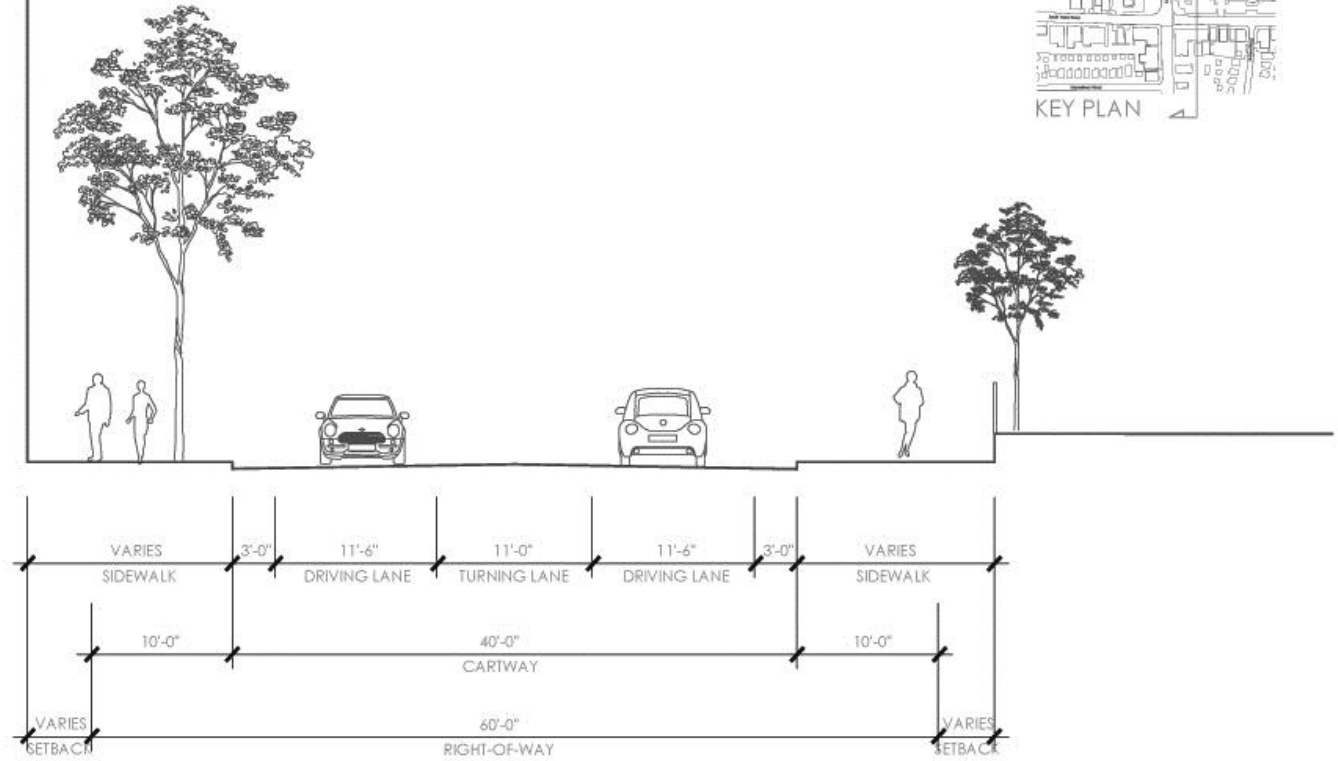
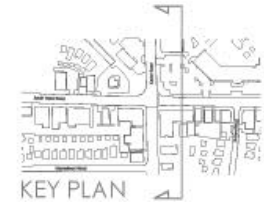

cedar taylor district

**idea book**

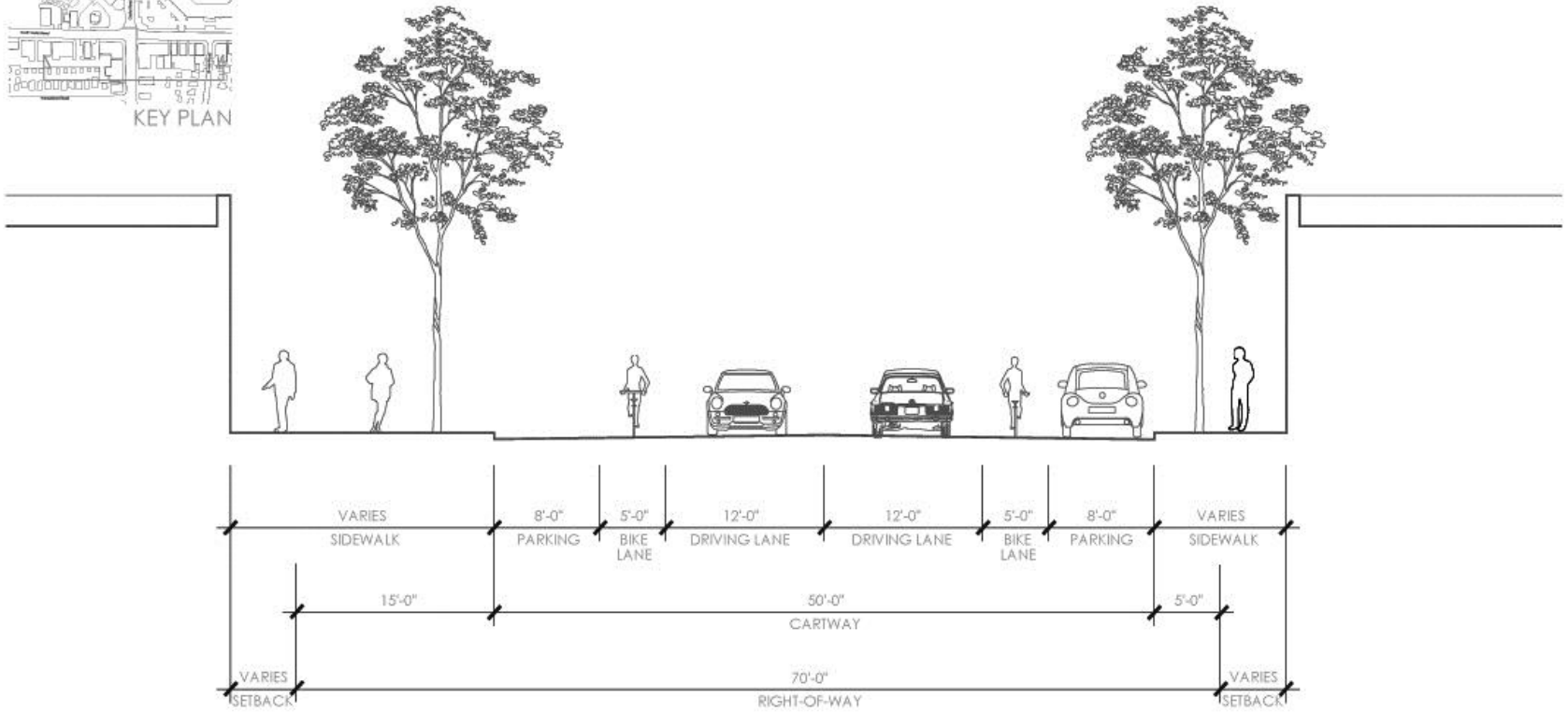

PROPOSED BIKE LANES - CEDAR ROAD

cedar taylor district

**idea book**



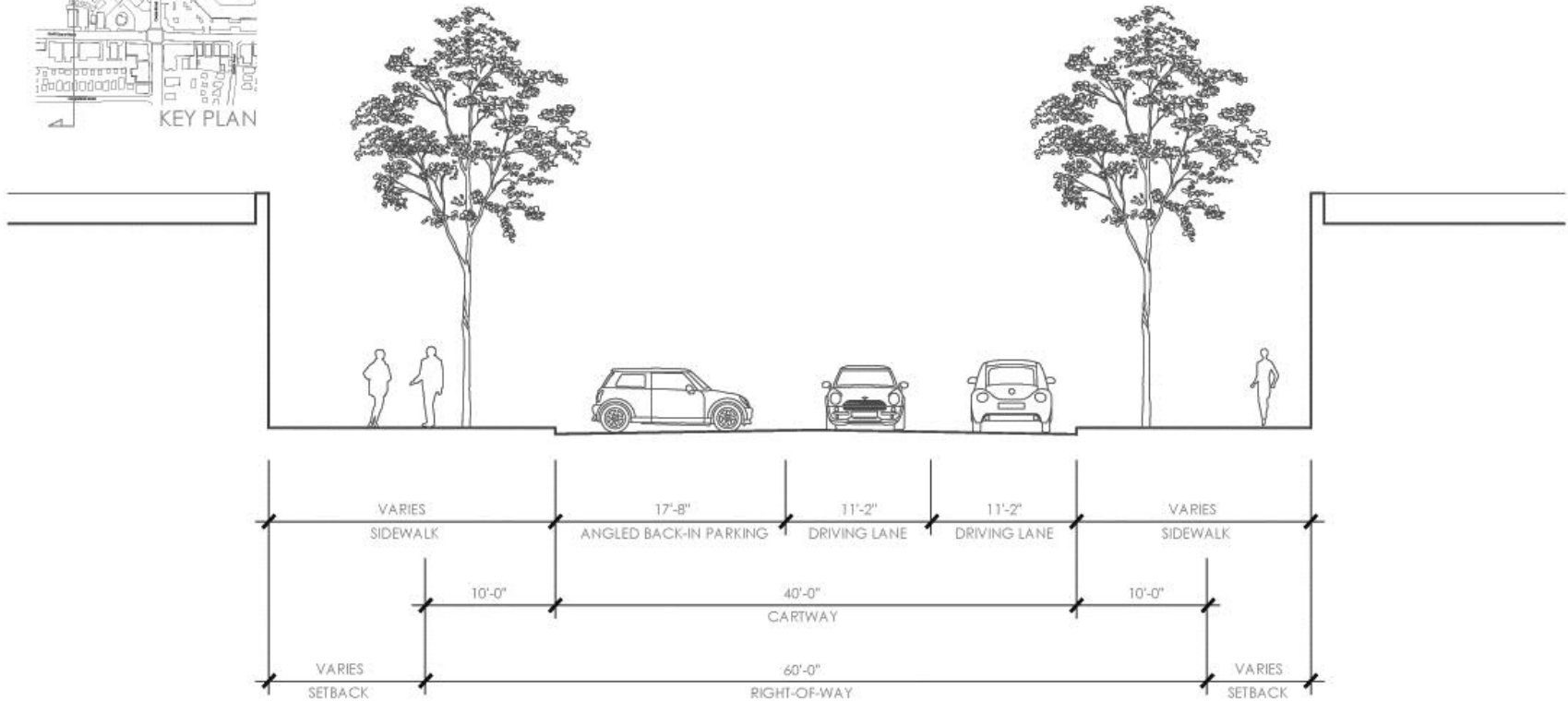

PROPOSED ON-STREET PARKING - SOUTH TAYLOR ROAD

cedar taylor district

**idea book**

# Infrastructure

Concepts for consideration



cedar taylor district

**idea book**

# Development

Concepts for consideration

- Playground / skate park
- Coffee shop
- Ice cream store
- Consolidated parking areas
- Additional 'destination' uses
- Bank branch / ATM
- Bike valet
- Coordinated storefront improvements
- Corner pocket park improvements
- Book box at bus stops

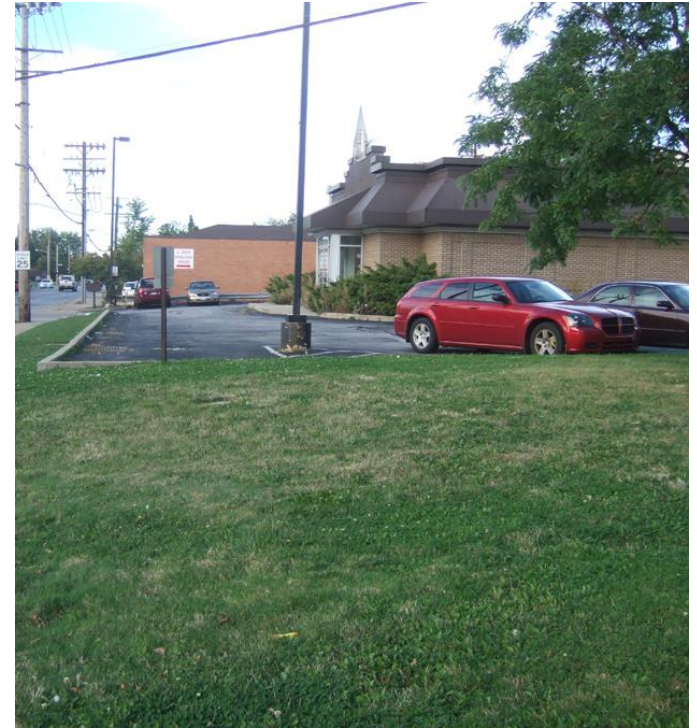

cedar taylor district

**idea book**



# Development

Concepts for consideration



cedar taylor district

**idea book**



# Design/Streetscape

Concepts for consideration

- Additional street trees
- Coordinated tree pit plantings
- Coordinated planters
- New street furniture
  - Benches
  - Trash cans
  - Bike racks
- Ornamental lighting
- Custom crosswalks & intersection art
- District signage
- Bike box @ shopping center



cedar taylor district

**idea book**

# Design/Streetscape

Concepts for consideration



cedar taylor district

**idea book**



# Design/Streetscape

Concepts for consideration

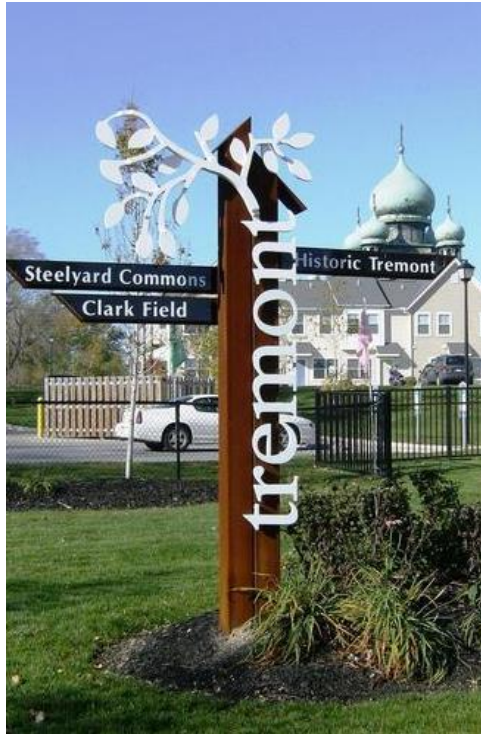

cedar taylor district

**idea book**

# Design/Streetscape

Concepts for consideration



cedar taylor district

**idea book**



# Programming

Concepts for consideration

- Pancake breakfast fundraiser
- Bike Day – parade, swap meet, safety clinics
- Art walk
- Jazz festival in rear parking area
- Chalk festival
- Mural competition for alleys & parking lot wall
- Balloon sculpture festival
- Winter festival/holiday street lighting



cedar taylor district

**idea book**

# Programming

Concepts for consideration



cedar taylor district

**idea book**



next steps /  
implementation

# Priority Projects

Listed in order of priority by type of project

## Infrastructure

### Near Term

- Dedicated left turn lanes
- Rear angled on-street parking
- Public parking lot improvements
- Updated bus stops

### Longer Term

- Bike lanes
- Power lines to tree pits

## Development

### Near Term

- Coordinated storefront improvements
- Playground / skate park at northern edge

### Longer Term

- Consolidated parking areas
- Coffee shop
- Bank branch / ATM
- Corner park improvements
- Bike valet service

## Design

### Near Term

- District signage
- New benches, trash cans & bike racks
- Coordinated tree pit plantings / planters
- Additional street trees

### Longer Term

- Ornamental / pedestrian lighting

## Programming

### Near Term

- Jazz festival in rear parking area
- Holiday lighting / winter festival
- Bike day – parade, swap meet, safety clinic

### Longer Term

- Mural competition for alleys and parking areas
- Farmer's market

cedar taylor district

**project sheet**



# District Identity

## Color Considerations

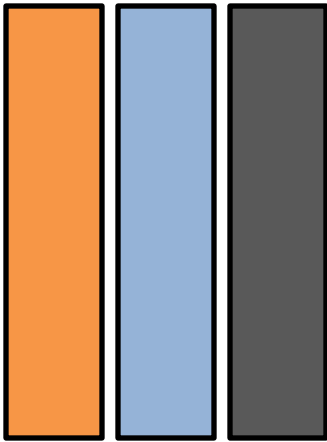

Option A

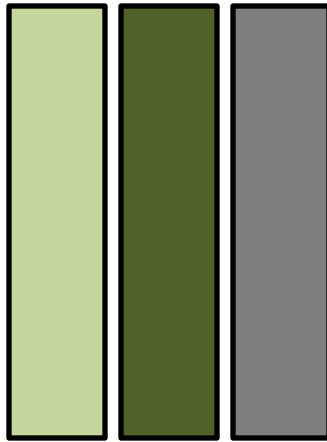

Option B

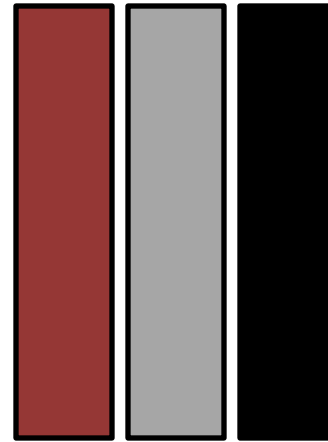

Option C

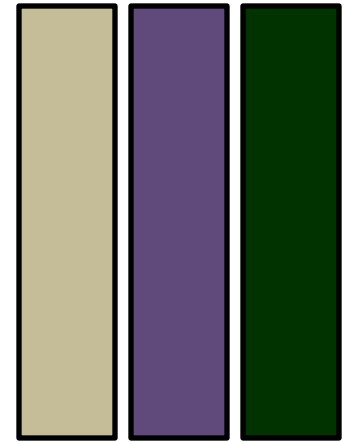

Option D

cedar taylor district

**project sheet**

# District Style

Classic / Simple



cedar taylor district

**project sheet**

# District Style

Historic



cedar taylor district

**project sheet**



# District Style

Modern

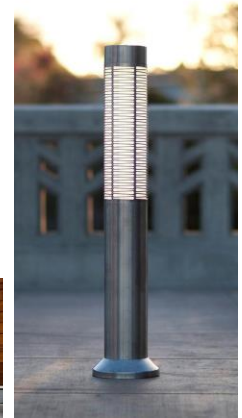

cedar taylor district

**project sheet**



# District Style

Eclectic



cedar taylor district

**project sheet**

# District Style

Preferred elements

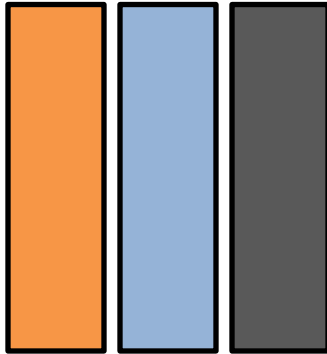

Basic color palette



Modern composite wood and metal benches



Continue with City standard trash receptacles, painted orange



Modern, tapered square concrete planters



Custom bike racks

cedar taylor district

**project sheet**



your thoughts,  
ideas & feedback

# Project credits

Special thanks to the following for making this project possible:

City of Cleveland Heights – *for project funding, review and planning support*

City of University Heights – *for project review and support*

The stakeholders of the Cedar Taylor District – *for their time, energy and ideas*



cedar taylor district

**idea book**