



Sustainable Community Associates
Owner | Developer



Park Synagogue
Mendelsohn Restoration

Cleveland Heights
Landmarks Commission

Certificate of Appropriateness
Synagogue Restoration & Addition

4 1 2025



Project Scope for Review & Approval:

- [1]
Historic Preservation and Adaptive Reuse of Erich Mendelsohn's Park Synagogue Temple & School Wing.
- [2]
Expansion of the Mechanical Room with a two story addition on the back of the Synagogue Temple.
- [3]
Demolition of the Boiler House, Caretaker Apartment, and Service Garage building.
- [4]
Demolition of Kangesser Hall with new entry at the end of the bridge.



Park Synagogue
Mendelsohn Restoration



Sustainable Community Associates

studio BC



NAYLORWELLMAN, LLC
HISTORIC PRESERVATION CONSULTING

Synagogue Restoration & Addition

Certificate of Appropriateness | 4 1 2025

***See Then & Now Photo Comparison under separate cover for exterior and interior photographs.**

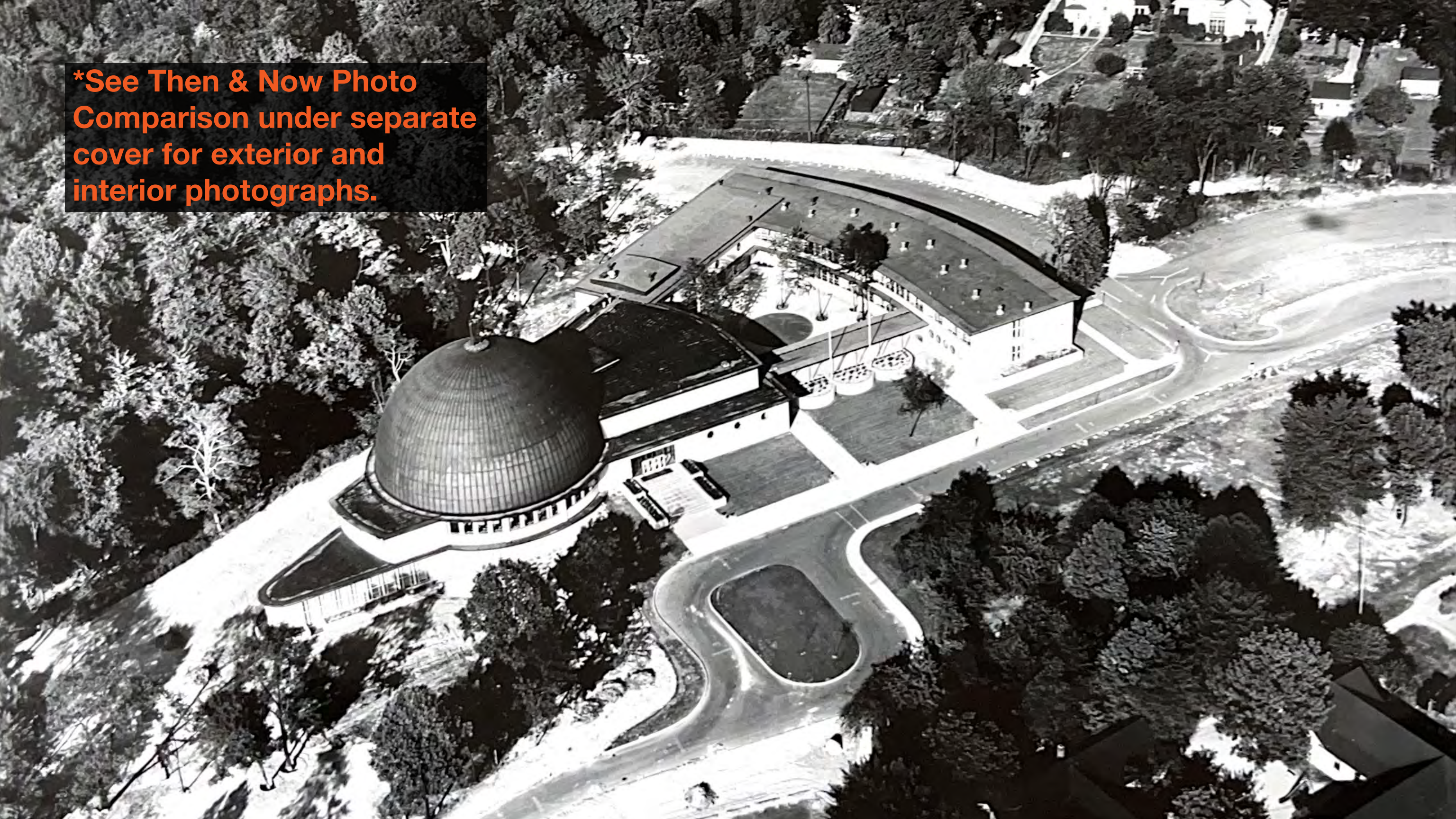

Park Synagogue
Mendelsohn Restoration



Sustainable Community Associates

studio BC

REED
HILDER
BRAND

NAYLORWELLMAN, LLC
HISTORIC PRESERVATION CONSULTING

Historic Aerial [c 1953]

Certificate of Appropriateness | 4 1 2025



not to scale

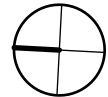

Park Synagogue
Mendelsohn Restoration



Sustainable Community Associates

studio BC



NAYLORWELLMAN, LLC
HISTORIC PRESERVATION CONSULTING

Existing Site Plan

Certificate of Appropriateness | 4 1 2025



Boiler House



School



Mikvah



Kangesser



Bridge

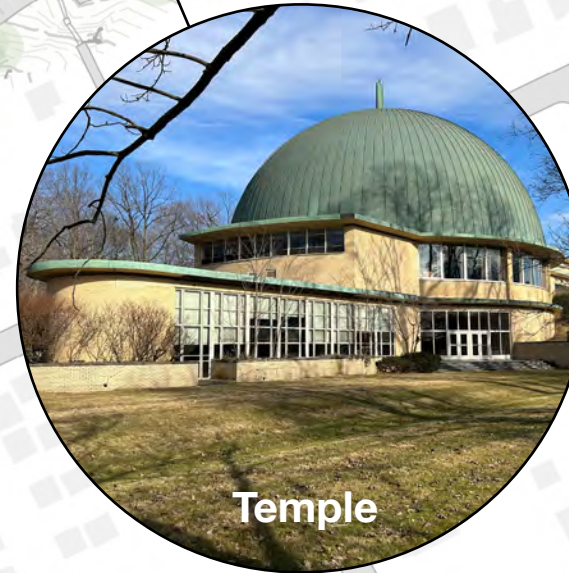

Temple



Daycare





not to scale



Park Synagogue
Mendelsohn Restoration



Sustainable Community Associates

studio BC

REED
HILDER
BRAND

NAYLORWELLMAN, LLC
HISTORIC PRESERVATION CONSULTING

Preliminary Site Plan

Certificate of Appropriateness | 4 1 2025



Park Synagogue
Mendelsohn Restoration



Sustainable Community Associates

studio BC

REED
HILDER
BRAND

NAYLORWELLMAN, LLC
HISTORIC PRESERVATION CONSULTING

Preliminary Landscape Plan

Certificate of Appropriateness | 4 1 2025

scale: 1/32" = 1'-0"

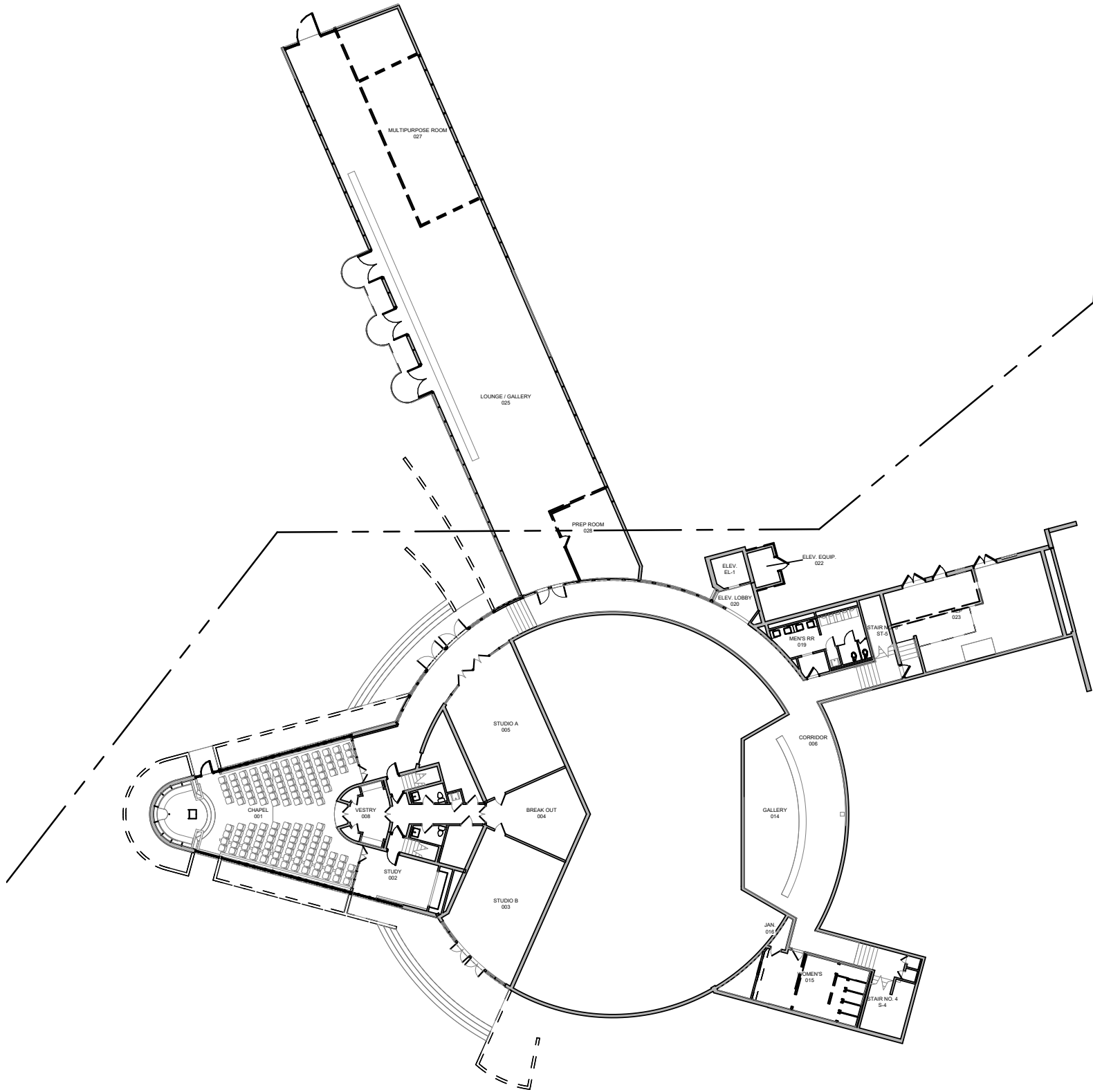
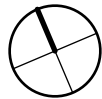

Park Synagogue
Mendelsohn Restoration



Sustainable Community Associates

studio BC

REED
HILDER
BRAND

NAYLORWELLMAN, LLC
HISTORIC PRESERVATION CONSULTING

Existing Ground Floor Plan

Certificate of Appropriateness | 4 1 2025

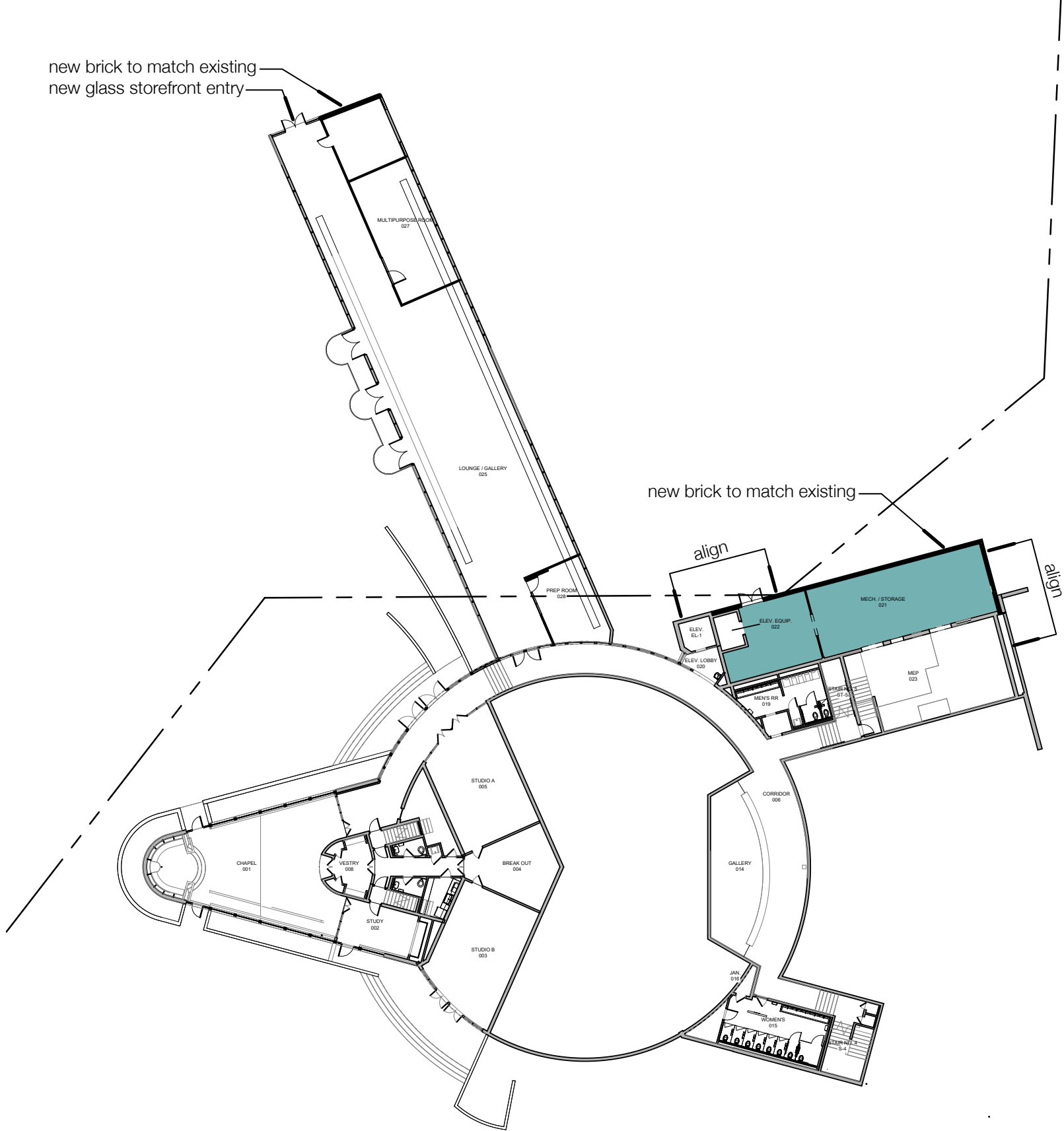

scale: 1/32" = 1'-0"



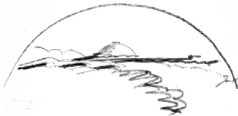
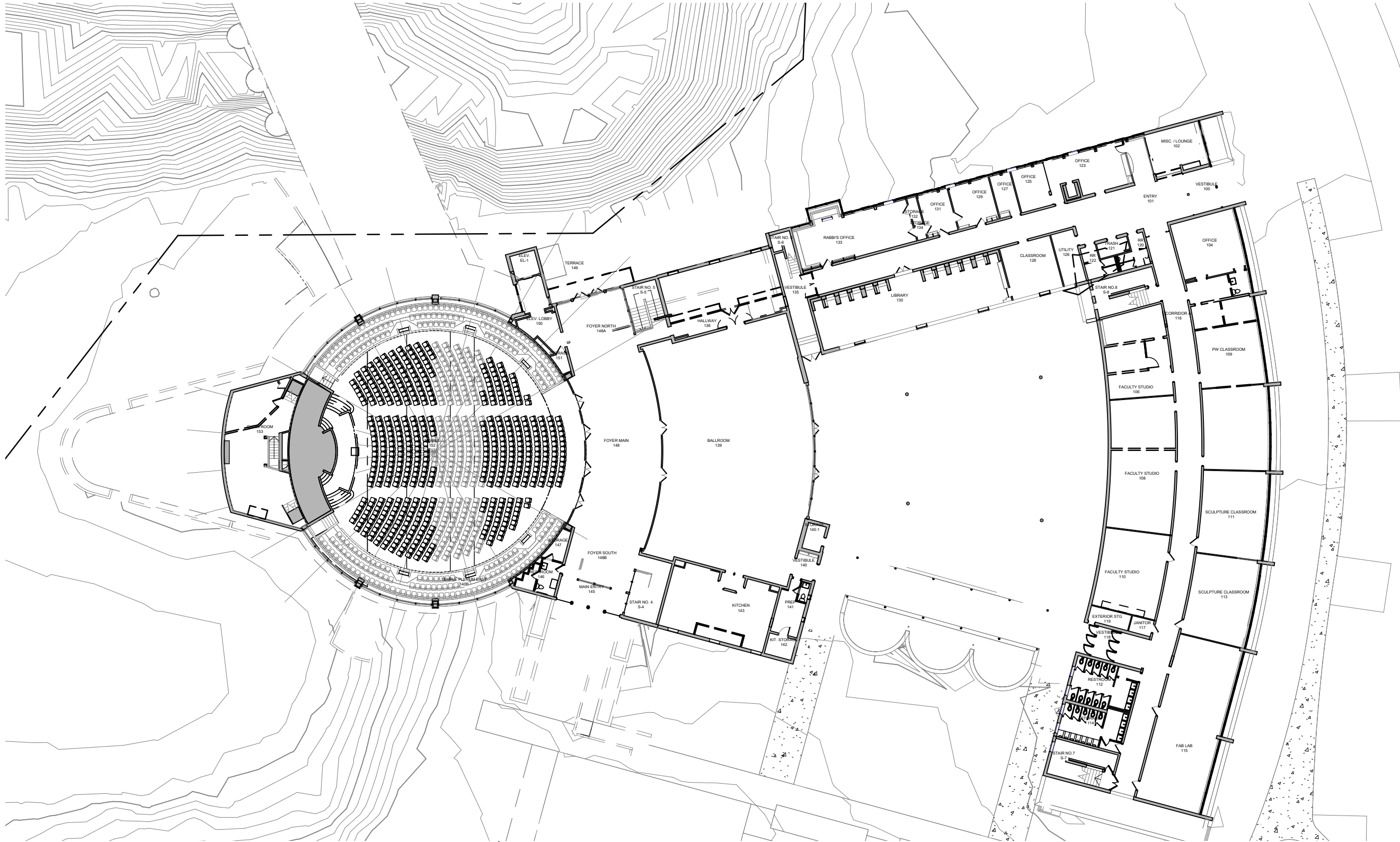
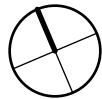



REED
+ HILDER
BRAND

NAYLORWELLMAN, LLC
HISTORIC PRESERVATION CONSULTING

Certificate of Appropriateness | 4 1 2025

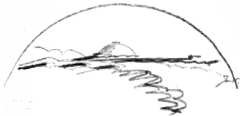
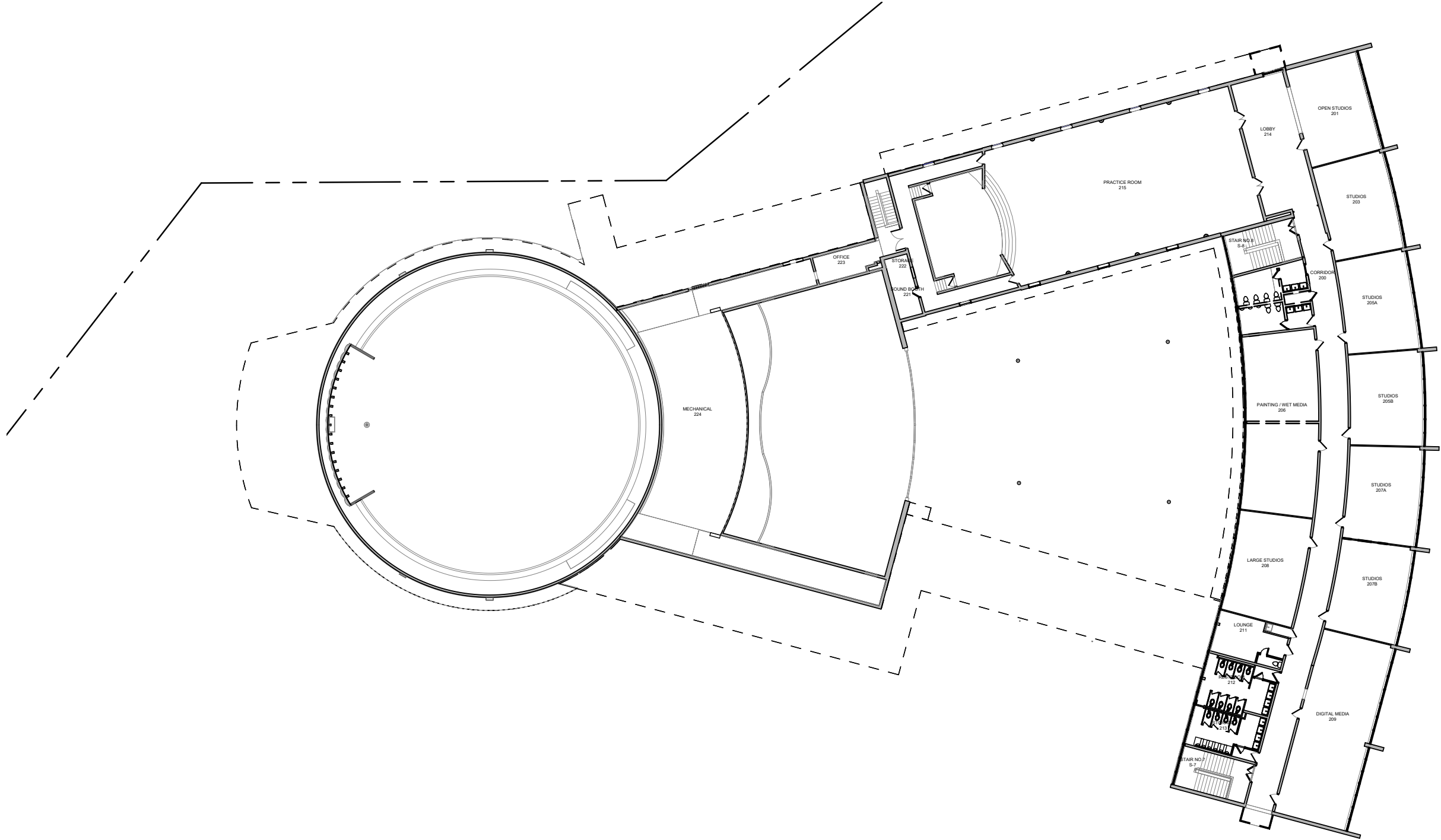
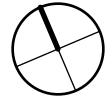

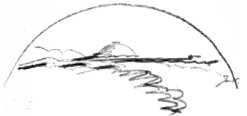
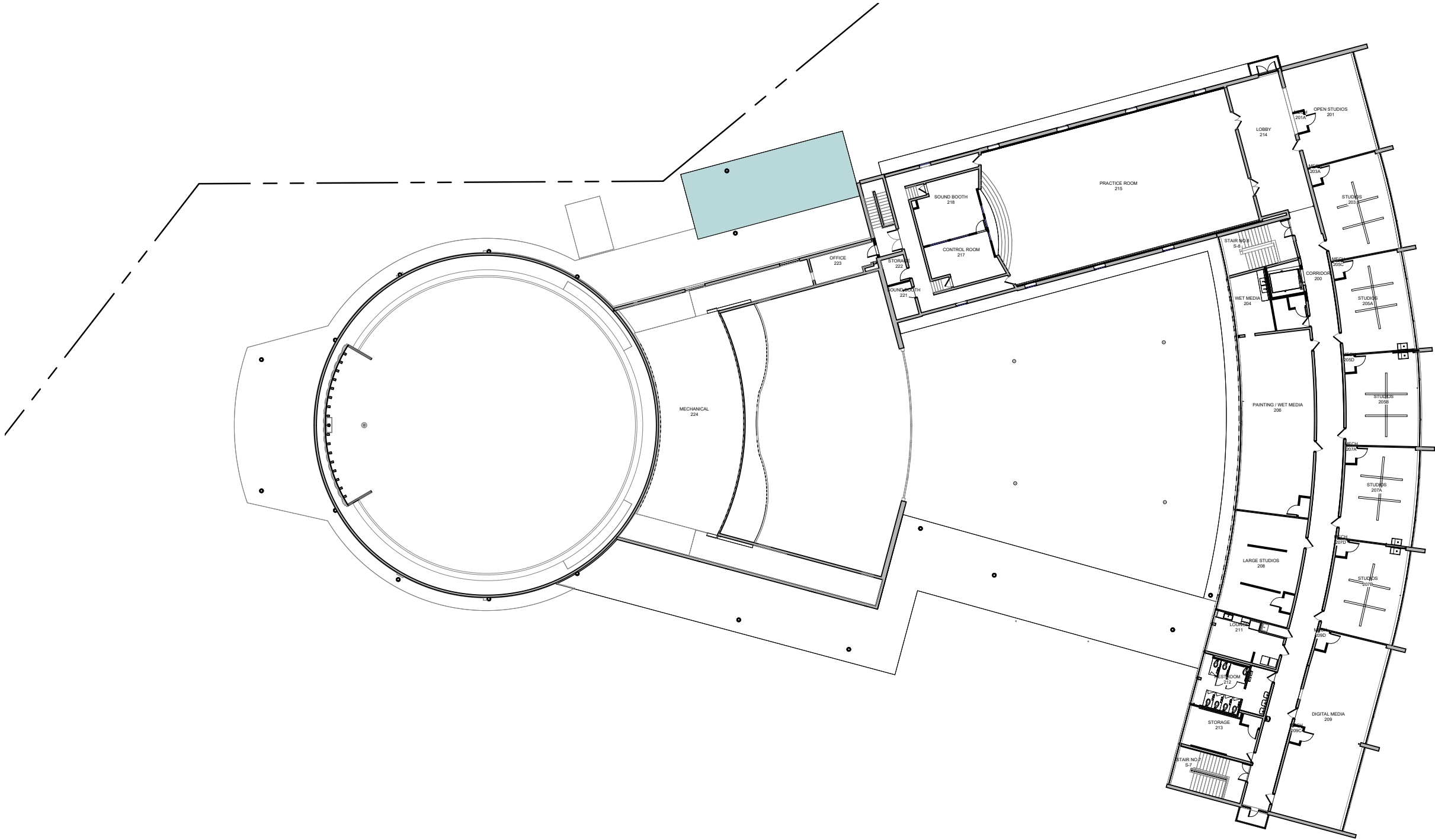
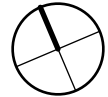

Park Synagogue
Mendelsohn Restoration



Sustainable Community Associates

studio BC



NAYLORWELLMAN, LLC
HISTORIC PRESERVATION CONSULTING

Proposed Second Floor Plan

Certificate of Appropriateness | 4 1 2025

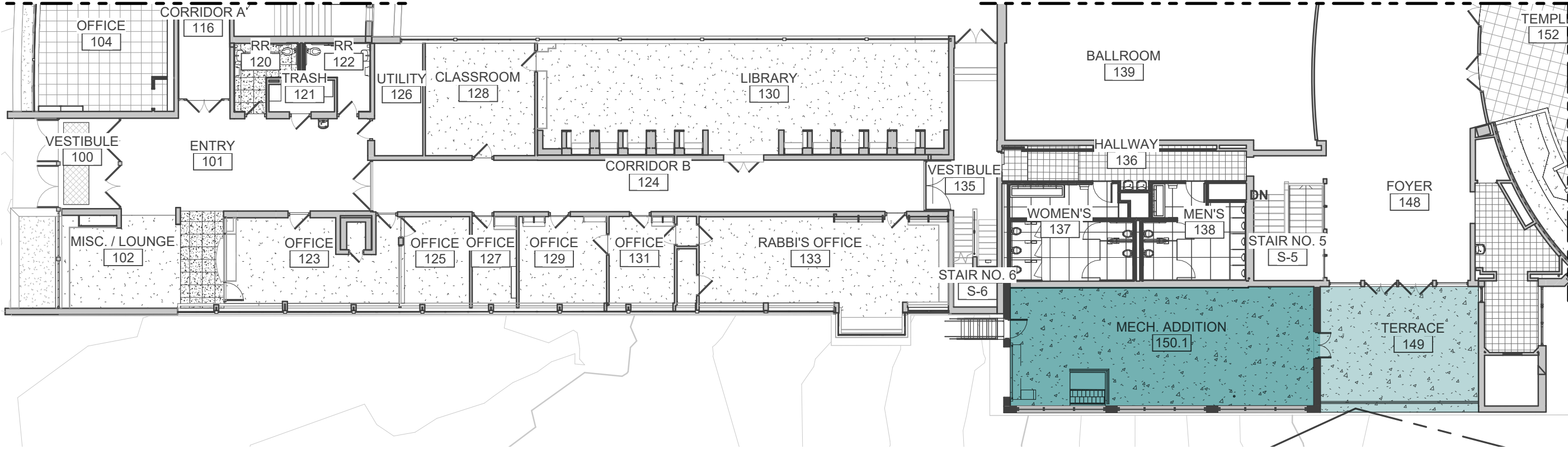
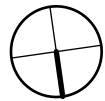



Park Synagogue
Mendelsohn Restoration



Sustainable Community Associates

studio BC



NAYLORWELLMAN, LLC
HISTORIC PRESERVATION CONSULTING

Existing North Elevation

Certificate of Appropriateness | 4 1 2025



Park Synagogue
Mendelsohn Restoration



Sustainable Community Associates

studio BC

REED
HILDER
BRAND

NAYLORWELLMAN, LLC
HISTORIC PRESERVATION CONSULTING

Proposed North Elevation

Certificate of Appropriateness | 4 1 2025





Park Synagogue
Mendelsohn Restoration



Sustainable Community Associates

studio BC

REED
HILDER
BRAND

NAYLORWELLMAN, LLC
HISTORIC PRESERVATION CONSULTING

Proposed East Elevation

Certificate of Appropriateness | 4 1 2025

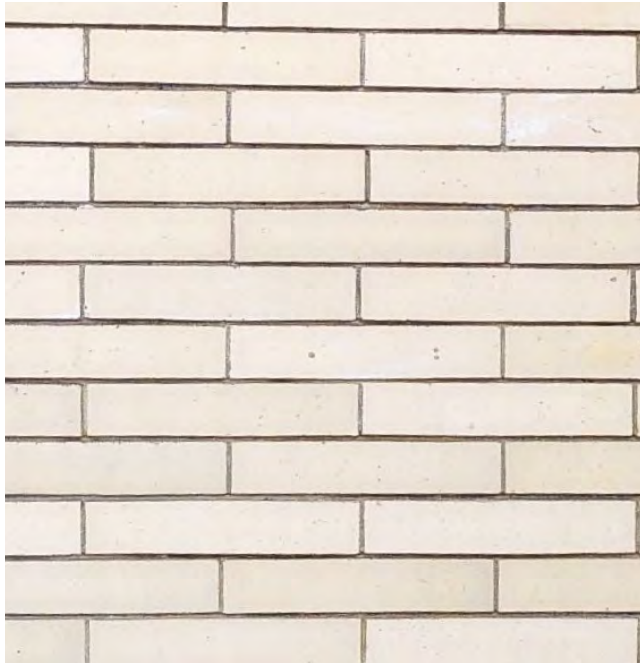

Existing Norman Brick



Existing anodized aluminum window



Existing aluminum louver



Existing utility door

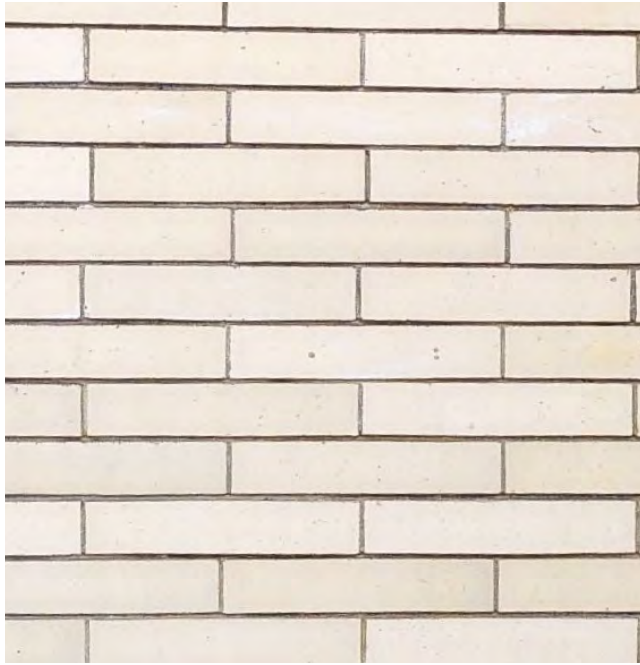

New Norman Brick



New anodized aluminum ribbon window



Prefinished aluminum louver to match Norman Brick

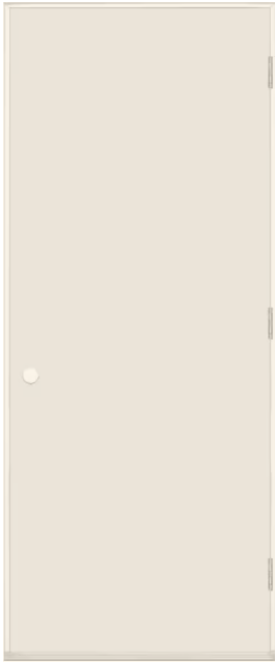

Fiberglass utility door and frame color to match Norman Brick



New metal equipment stair



Park Synagogue
Mendelsohn Restoration